

Soils Map

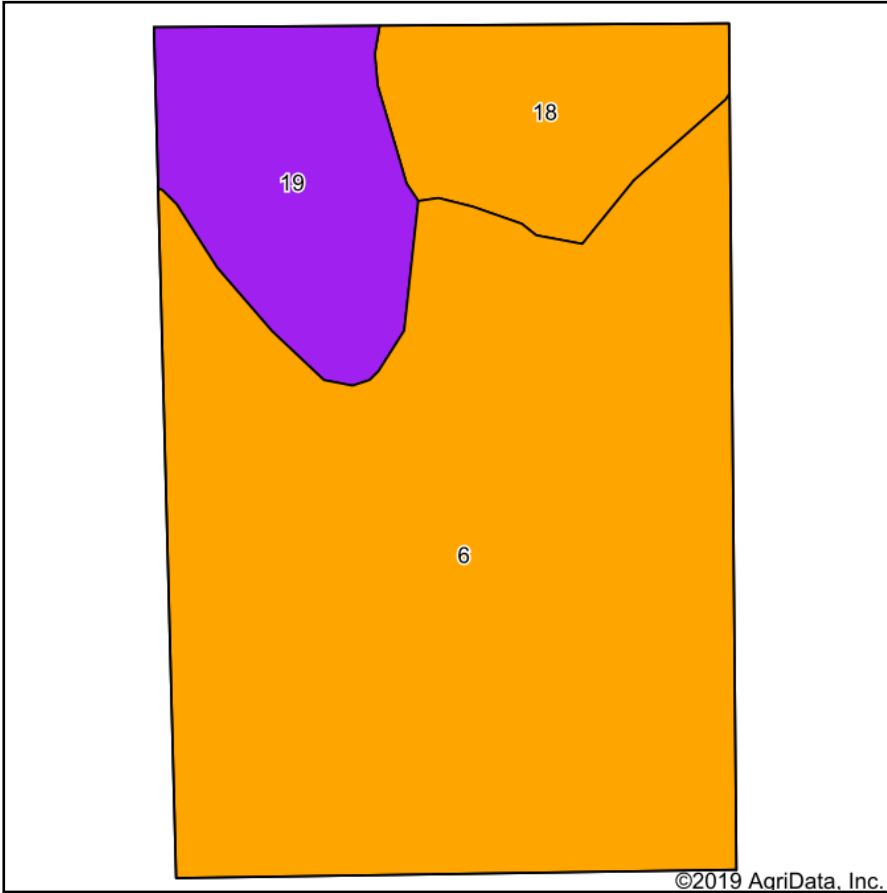

Soils data provided by USDA and NRCS.

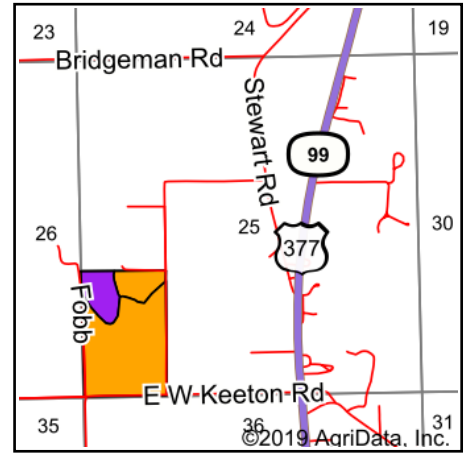

State: **Oklahoma**
 County: **Marshall**
 Location: **25-7S-4E**
 Township: **South Marshall**
 Acres: **59.49**
 Date: **4/28/2020**



Maps Provided By:



Area Symbol: OK095, Soil Area Version: 15

| Code | Soil Description | Acres | Percent of field | Non-Irr Class Legend | Non-Irr Class *c | Caucasian bluestem | Cotton lint | Grain sorghum | Improved bermudagrass | Introduced bluestem | Oats | Peanuts | Peanuts Irrigated | Rye | Small grains grazeout | Soybeans | W |
|-------------------------|--|-------|------------------|----------------------|------------------|--------------------|-------------|---------------|-----------------------|---------------------|-------------|--------------|-------------------|------------|-----------------------|------------|---|
| 6 | Dougherty loamy fine sand, 0 to 3 percent slopes | 43.74 | 73.5% | | IIle | 5 | 23 | 31 | 4 | 4 | 34 | 1108 | 2070 | 1 | 3 | 2 | |
| 19 | Konawa fine sandy loam, 3 to 8 percent slopes, gullied | 8.64 | 14.5% | | VIe | 5 | | | 3 | 4 | | | | | | | |
| 18 | Konawa fine sandy loam, 1 to 5 percent slopes, eroded | 7.11 | 12.0% | | IIle | 5 | 300 | 35 | 4 | 4 | 30 | 1000 | | 25 | 3 | | |
| Weighted Average | | | | | | 5 | 52.8 | 27 | 3.9 | 4 | 28.6 | 934.2 | 1522 | 3.7 | 2.6 | 1.5 | |

*n: The aggregation method is "Weighted Average using major components"

*c: Using Capabilities Class Dominant Condition Aggregation Method

Soils data provided by USDA and NRCS.